

Western Unincorporated Townships

Zoning By-law 14-01
Schedule A8
Township of Cox

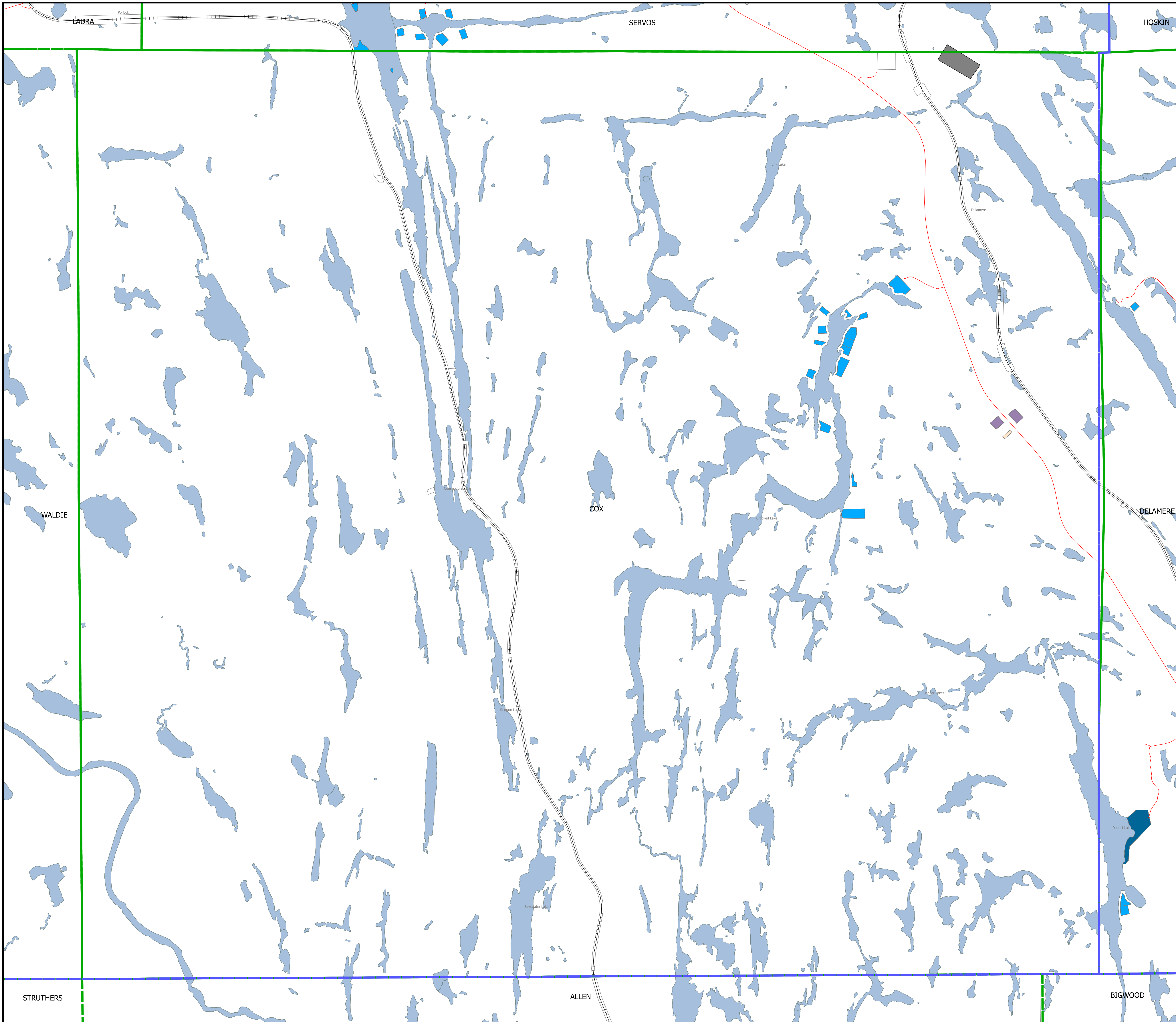
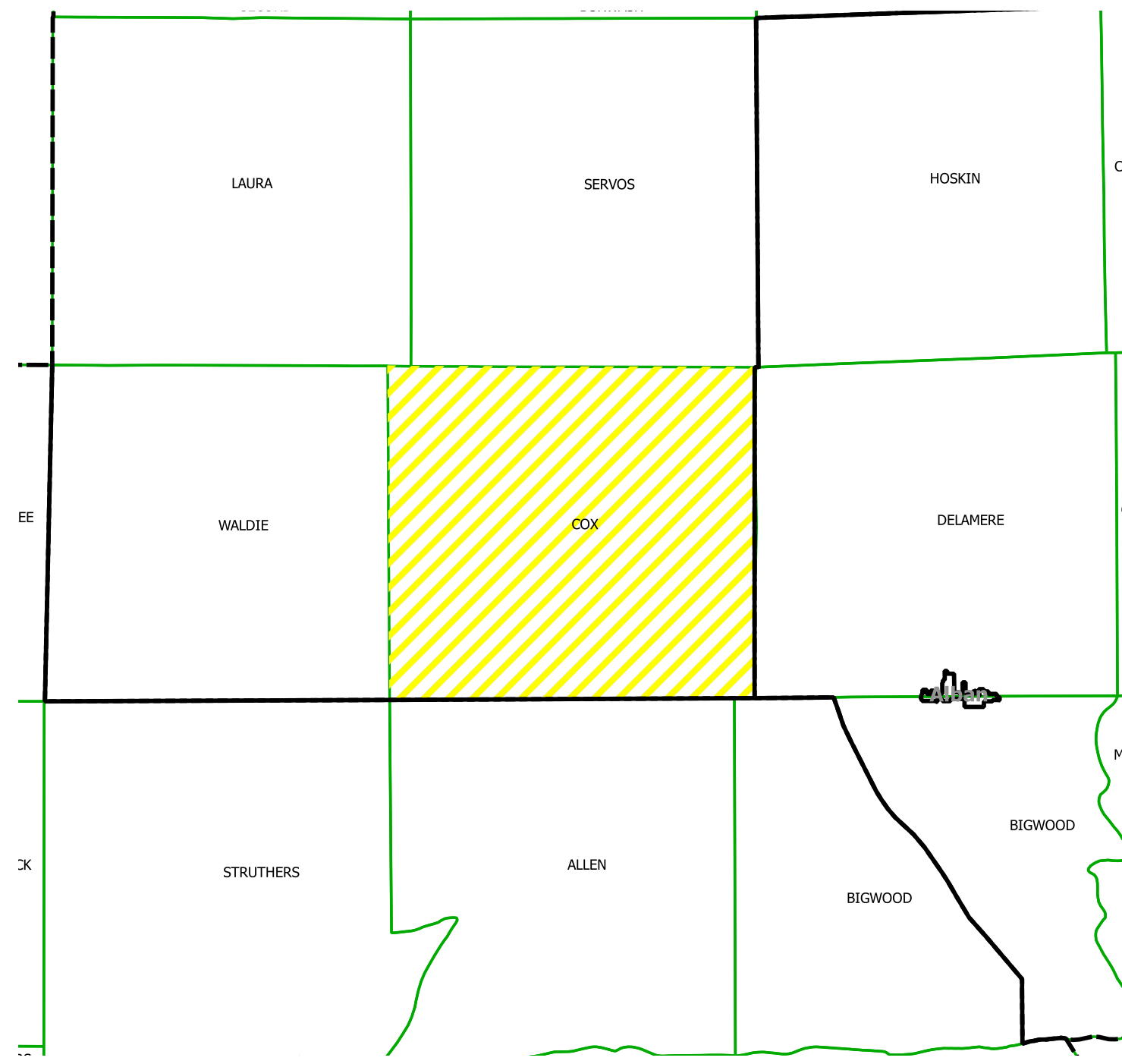

- | | |
|-------------------------------------|--------------------------|
| Zoning Classification | Base Map Features |
| Residential One (R1) | Railway |
| Residential Two (R2) | Powerlines |
| Residential Mobile Home Park (RMH) | Parcel Boundaries |
| Residential Rural (RR) | District Boundaries |
| Waterfront Residential (WR) | Township Boundaries |
| Commercial Community (CC) | |
| Commercial Highway (CH) | |
| Waterfront Commercial Tourist (WCT) | |
| Industrial Rural (MR) | |
| Industrial General (MG) | |
| Waste Disposal (MD) | |
| Mineral/Mining Extraction (MX) | |
| Institutional One (I1) | |
| Institutional Two (I2) | |
| Open Space (OS) | |
| Waterfront Landing (WL) | |
| Rural (RU) | |
| Special Provisions | |

Prepared by:
CGIS Spatial Solutions
52 South Street
Perth, ON K7H 2G7
TEL: 613-368-4321
www.cgis.com

Draft Date: June 17, 2014

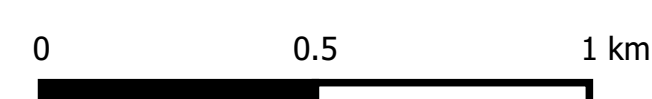
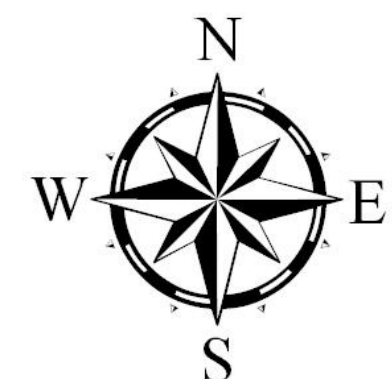

Note: The base information on this plan was prepared from a variety of map sources and was used by permission of the Sudbury East Planning Board. It is not a legal plan of survey. For precise location of plan features recourse should be had to the original source data.